



JAMMU AND KASHMIR MEDICAL SUPPLIES CORPORATION LTD.

(Public Sector Undertaking of the Government of Jammu and Kashmir)

Corporate Head Office: GMC Complex, Bakshi Nagar, Jammu (J&K)-180006, Tele : 0191-2580842

Corporate Office: 121-Green Avenue, Hyderpora (J&K)-190014: Telefax: 0194-2432008

email: jkscljepm@gmail.com; website: www.jkmscl.nic.in

C O R R I G E N D U M

Subject : Corrigendum 6 E-bid for Annual Rate Contract for the Supply and Installation of 16 Slices CT Scan Machine.

In light of the decisions taken during the pre-bid meeting held on 19.11.2016 & recommendations/suggestions made by the technical experts from on the basis of suggestions/representation made by the firms/bidders, the following incorporations/amendments have been made :

Point No.	Specifications in tender document	Amendments : Please read the specification column (3) amended as :-
1	2	3
Page 13, 3.10	The scanned copy of complete bid document filled and signed on each page as per Instructions to bid (ITB) and other requirements need not to uploaded on website www.jktenders.gov.in . However, declaration regarding acceptance of all the terms & conditions and other clauses as given in the tender document duly notarised shall have to be uploaded along with technical bid. Bidders shall submit the bid document in Physical form. Moreover hard copy of the detailed financial bid is to be submitted by technically qualified bidders before the opening of financial bid.	The scanned copy of complete bid document filled and signed on each page as per Instructions to bid (ITB) and other requirements need not to uploaded on website www.jktenders.gov.in . However, declaration regarding acceptance of all the terms & conditions and other clauses as given in the tender document duly notarised shall have to be uploaded along with technical bid. Bidders shall submit the bid document in Physical form. Moreover hard copy is to be submitted atleast two days prior to the opening of technical bid. Hard copy is for reference of uploaded document only. Documents which are not uploaded shall not be considered for reference.
Page 19 Col. 8	I/We understand that you are not bound to accept the lowest evaluated bid or any other bid that you may receive.	To be read as deleted
Page 19 Col. 9	I/We agree to permit the JKMSCL or its representative to inspect our accounts and records and other documents relating to the bid submission and to have them audited by auditors appointed by the JKMSCL.	I/We agree to permit the JKMSCL to ask any relevant document. I/we shall be bound to provide the said relevant document within the specified period.
Page 21 Col. 7	I/We understand that you are not bound to accept the lowest evaluated bid or any other bid that you may receive.	To be read as deleted
Page 21 Col. 8	I/We agree to permit the JKMSCL or its representative to inspect our accounts and records and other documents relating to the bid submission and to have them audited by auditors appointed by the JKMSCL.	I/We agree to permit the JKMSCL to ask any relevant document. I/we shall be bound to provide the said relevant document within the specified period.
Page 33 (2.1.1)	Supply order shall be placed through registered post/e-mail/any communication medium by the JKMSCL. The date of	Supply order shall be placed through registered post/e-mail/any communication medium by the JKMSCL. The date of receipt of e mail/fax/other

	<p>receipt of e mail/fax/other communication shall be treated as the date of order for calculating the period of execution of order. The successful bidder shall execute the orders within a delivery period of 60 days or as specified in the supply order.</p>	<p>communication shall be treated as the date of order for calculating the period of execution of order. The successful bidder shall execute the orders within a delivery period of 60 days or as specified in the supply order and handing over of space with the availability of power & other requisite installations by the end users.</p>
<p>Page 35 (2.7.1)</p>	<p>90% payment shall be made within 30 days of supply, installation & successful commissioning to the satisfaction of the committee of JKMSCL. 10% after the completion of six months training of the staff onsite/at company's location. If installation is not possible in three months due to non preparation of the site for installation, the end user shall give certificate in this regard and 90% of the payment shall be released after submission of Bank Guarantee valid upto installation and commissioning of equipment. The qualified bidders shall visit the office of the end user to ensure the preparation of site immediately after issuance of LOI. Payment shall be released on receipt of certificate of supply as per specifications and in good condition from the consignee along with the bill. Installation / commissioning of equipment and rendition of required satisfactory training to the consignee's personnel, if any, shall also be necessary for releasing payment. In case of delayed supplies, deduction of liquidated damages as per provisions shall be made from payments. The firms shall have to seek time for extension from the JKMSCL before executing delayed supplies.</p>	<p>90% payment shall be made within 30 days of supply, installation & successful commissioning to the satisfaction of the committee of JKMSCL. 10% after the completion of six months training of the staff onsite/at company's location. If installation is not possible in three months due to non preparation of the site for installation, the end user shall give certificate in this regard and 90% of the payment shall be released after submission of Bank Guarantee valid upto installation and commissioning of equipment. The qualified bidders shall visit the office of the end user to ensure the preparation of site immediately after issuance of LOI. Payment shall be released on receipt of certificate of supply as per specifications and in good condition from the consignee along with the bill. Installation / commissioning of equipment and rendition of required satisfactory training to the consignee's personnel, if any, shall also be necessary for releasing payment. In case of delayed supplies, deduction of liquidated damages as per provisions shall be made from payments. The firms shall have to seek time for extension from the JKMSCL before executing delayed supplies.</p> <p>In case of Imported item(s), LC for 100% payment shall be issued.</p>
<p>Page 75</p>	<p>X-Ray Generator:</p> <ol style="list-style-type: none"> 1. The X-ray generator should be high frequency generator with output of at least 24 and above. 2. The mA range available should atleast be 50mA to 300mA. 	<p>X-Ray Generator:</p> <ol style="list-style-type: none"> 1. The X-ray generator should be high frequency generator with output of at least 24 or above. 2. The mA range available should atleast be 10mA to 400mA.
<p>Page 75</p>	<p>X-Ray Tube:</p> <ol style="list-style-type: none"> 1. The X-ray tube should be 	<p>X-Ray Tube:</p> <ol style="list-style-type: none"> 1. The X-ray tube should be essentially

	<p>essentially dual focus with capacity of more than 2 MHU.</p> <p>2. The X-ray tube should have a cooling rate of not less than 300 KHU per min and above.</p>	<p>dual focus with capacity of more than 2 MHU or more.</p> <p>2. The X-ray tube should have a cooling rate of 300 KHU per min or more.</p>
Page 75	<p>Gantry:</p> <p>The gantry should have a physical tilt of +/-30 degrees or more and remote tilt should be available as standard.</p>	<p>Gantry:</p> <p>The gantry should have a physical/digital tilt of +/-30 degrees or more and remote tilt should be available as standard.</p>
Page 75	<p>Patient Table:</p> <p>4. The vertical range should be at least 35 cms (maximum height-minimum height).</p> <p>5. Remote UP/DOWN, Forward and Backward movements should be standard.</p>	<p>Patient Table:</p> <p>To be read as optional.</p>
Page 76	<p>Spiral Section:</p> <p>The scanner should be able to simultaneously acquire 16 or more slices per rotation with slice thickness of 0.625 mm or lower.</p>	<p>Spiral Section:</p> <p>The scanner should be able to simultaneously acquire 16 or more slices per rotation with slice thickness of 0.625 mm or more.</p>
Page 76	<p>Spiral Section</p> <p>6. For intervention procedures CT Fluoroscopy with in room monitor to be quoted as standard.</p>	<p>To be read as deleted</p>
Page 77	<p>Accessories :</p>	<p>To be provided in addition to the Accessories asked in the NIT :</p> <ul style="list-style-type: none"> - Three lead aprons of reputed make. - Fifty syringes for pressure injector
Page 78	<p>Warranty and CMC:</p> <p>The product has to be AERD, CE marked and FDA approved. The offer should be accompanied by original product data sheet/brochure of the product.</p>	<p>Warranty and CMC:</p> <p>The product has to be AERB/CE marked/ FDA approved. The offer should be accompanied by original product data sheet/brochure of the product.</p>
		<p>To be added :</p> <p>Training of CT Technician & Radiologist at site for 04 weeks is required.</p>

Please Note :

1. *Those firms/bidders who have already uploaded his/her bid are required to re-uploaded their bids as per the amended specifications and corrigendum issued thereof.*
2. *Only technical/financial bids uploaded as per revised corrigendum shall be considered for evaluation.*

All the bidders are requested to keep themselves updated & submit their e-bids through e-portal www.jktenders.gov.in as per specifications & BOQs. The amendments/modifications shall be available on www.jktenders.gov.in, and www.jkmsclbusiness.com.

-Sd-
Dr. Rajinder Kr. Khajuria, KAS
General Manager ó J(Adm)

No.: JKMSCL/Corg/2016/ 57

Dated: 25.11.2016

Copy for information to the:-

- 1 Managing Director, JKMSCL, Jammu.
- 2 Financial Advisor / Chief Accounts Officer, JKMSCL, Jammu.

DOCTORS
REPAIRING
ROOM

CT SCAN
WAITING
AREA

ENT / EYE / EAR
SECTION

CT Gantry ROOM

CONSOLE
ROOM

TRAIN ROOM

LABORATORY

GENERAL RADIO, CB
REPAIR SECTION AND
STATION

CT OFFICE

STORAGE

Site Plan of CT Scan Room for District Hospital Pulwama J&K

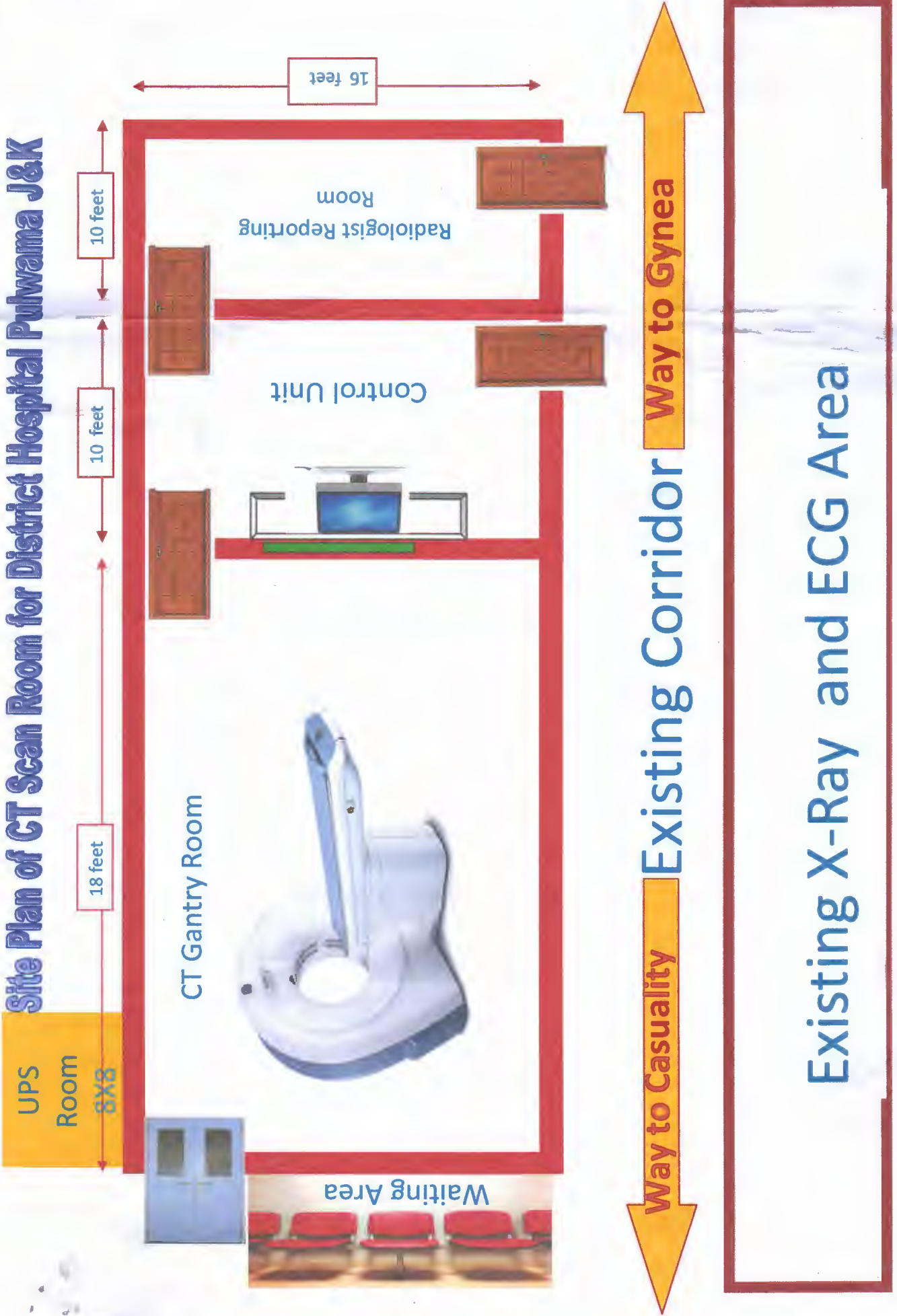

(Signature)
 Medical Superintendent
 DISTRICT HOSPITAL
 Pulwama, Kashmir
 Radiologist

Service floor lined with 2.0 mm lead.

625 cm

200 cm

400 cm

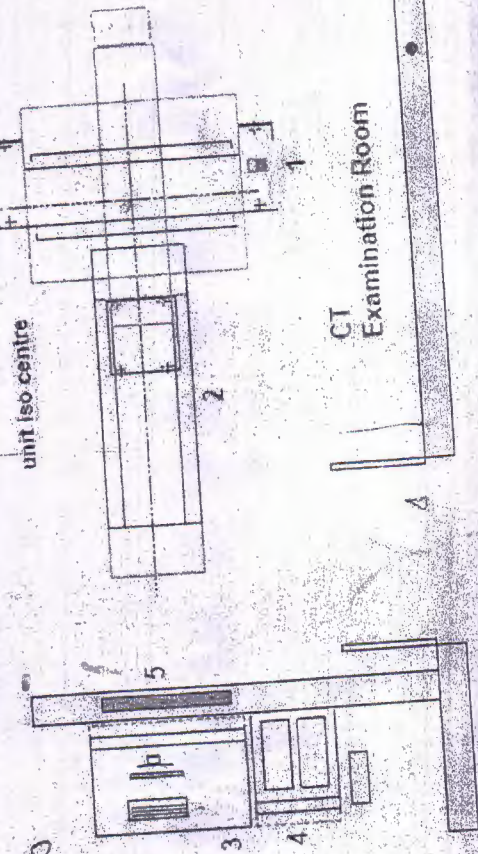

Legend:

- 1. CT gantry
- 2. Examination Table
- 3. Control Unit
- 4. Electronics
- 5. Viewing Glass 100 cm X 80 cm of 2.0 mm lead equivalence

All dimensions are in cm
Scale 1:50

All walls of the Examination Room are 23cm (9" thk. made of bricks.

Double leaf door lined with 2.0 mm lead.

Model Name:
Manufacturer:

Signature of applicant:
Name of the Institution:
Stamp of the Institution: